

**Warnings and Instructions: Review carefully, proper application is required**

**⚠ Warning:** This device will not prevent or eliminate risk of injury. Do Not Overtighten. If swelling, pain, skin irritation, or an unusual reaction occurs, discontinue use immediately and consult your medical professional. This device should not be worn by persons with known allergies to neoprene. Care: Hand wash using mild soap. Rinse thoroughly. Air dry only. Do not tumble dry.

**Mallet Finger Application**

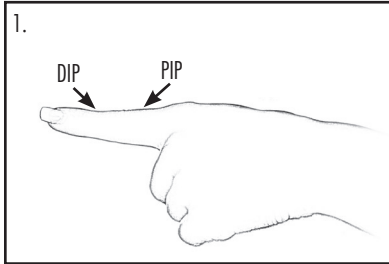

1. The DIP joint must be kept in a straight position at all times. Holding the fingertip on the edge of a counter, place the splint on the nail side of the finger with the rubber surface in contact with the skin.

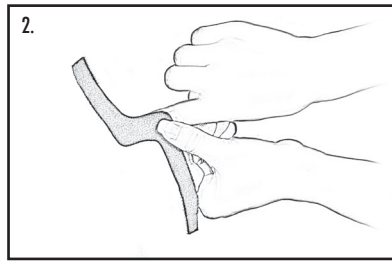

2. Apply the splint with the transverse strap closer to the hand and the angled strap over the nail.

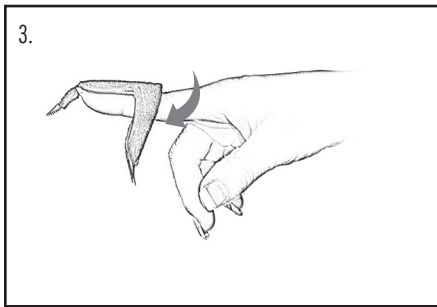

3. Secure the transverse strap.

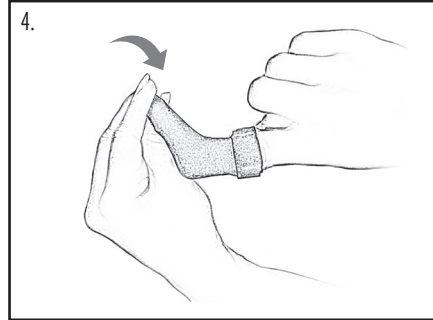

4. Secure the angled strap. The straps should hold the splint firmly, but should not be too tight as to interfere with circulation to the fingertip.

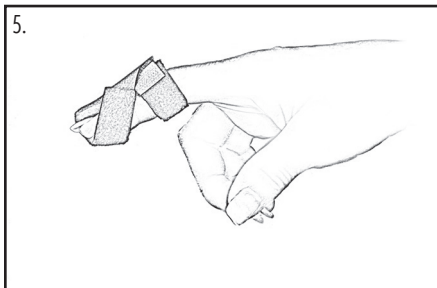

5. Completed application. The PIP joint should move freely.



**Warnings and Instructions: Review carefully, proper application is required**

**⚠ Warning:** This device will not prevent or eliminate risk of injury. Do Not Overtighten. If swelling, pain, skin irritation, or an unusual reaction occurs, discontinue use immediately and consult your medical professional. This device should not be worn by persons with known allergies to neoprene. Care: Hand wash using mild soap. Rinse thoroughly. Air dry only. Do not tumble dry.

**PIP Immobilization Application**

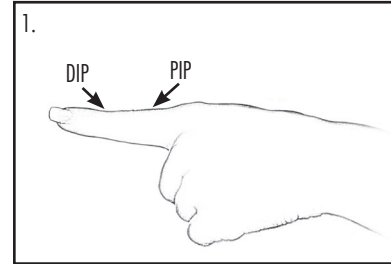

1. With the finger straight apply the brace to either include the PIP and DIP joints or just the PIP joint depending on indication.

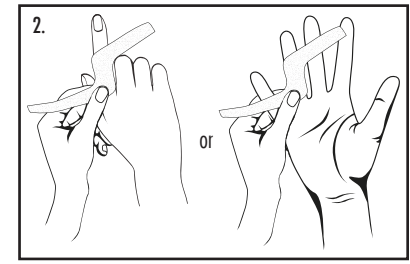

2. Decide if the splint will be applied on the top (dorsally) or bottom (volarly) of the finger.

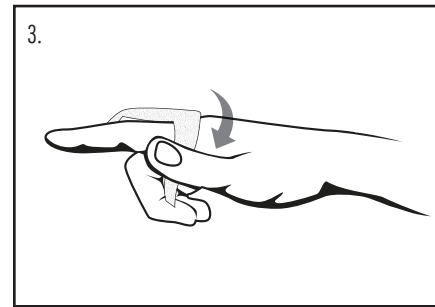

3. Apply the splint with the transverse strap closer to the hand and the angled strap towards the fingertip.

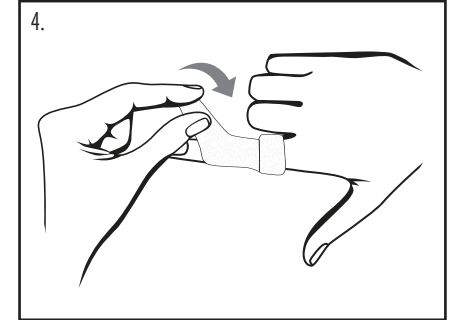

4. Secure both straps.

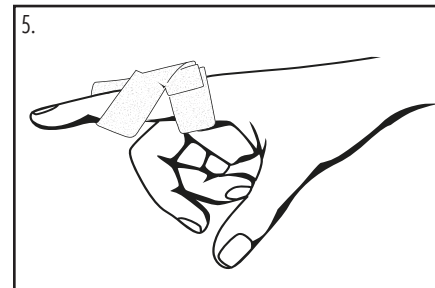

5. Completed application.

